

FRONTIER™ PRO

ULTRALIGHT WATER FILTER

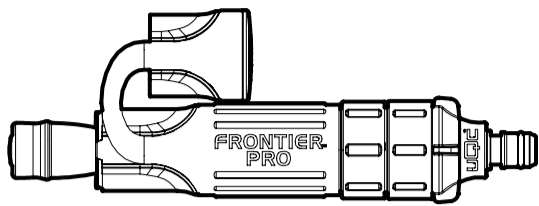

USER MANUAL

Model Number 67006, 67106

EPA Est. No 71766-UT-001

FRONTIER™ PRO

INTRODUCTION

Thank you for purchasing The Frontier™ Pro Ultralight Water Filter. The multi-functional Frontier™ Pro is the "go-to" choice of ultralight backpackers, preppers and survivalists alike.

FEATURES

- New replaceable Series III GRN Line filter removes bacteria, Cryptosporidium and Giardia.
- Connects to bottles, bladders and gravity flow systems.
- Patented "Cap-Strap" protects mouthpiece from contamination
- 2.5 Ounce dry weight
- Replaceable prefilter disks
- Miraguard™ Antimicrobial* Technology

CAUTIONARY STATEMENTS

- CAUTION - To avoid cross contamination: Do not handle filter or mouthpiece with wet hands that have been exposed to contaminated water. Do not submerge filter or mouthpiece in contaminated water.
- CAUTION - Do not freeze filter or expose filter to extreme temperatures
- CAUTION - The Frontier Pro Water Filter contains small parts - Keep away from children

COMPONENTS

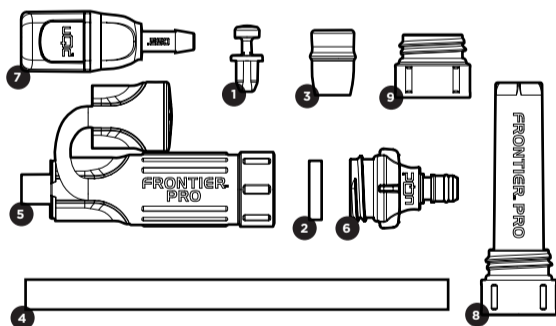

PARTS LIST

PART #	ITEM NAME
1	Valve Insert
2	Pre-filter
3	Valve Sheath
4	Straw
5	Frontier Pro
6	UQC Pre-filter Adapter
7	UQC Valve Body
8	Series III Filter
9	Pre-Filter/Straw Adapter

REPLACEMENT AND COMPATIBLE PARTS

PART #	ITEM NAME
67013	Replacement Filter GRN Line
67023	1/4" UQC Splice Adapter Kit
67024	5/16" UQC Splice Adapter Kit

HOW TO USE THE FRONTIER MAX

The Frontier™ Pro is designed for ease of use and reliable service. To ensure proper performance please follow these simple steps.

UQC INSTRUCTIONS

Note: The Frontier™ Pro is designed with a Universal Quick Connect (UQC™) pre-filter adapter. The UQC allows you to attach the Frontier™ Pro to your existing hydration system without the need to cut tubing. Simply attach the UQC pre-filter adapter directly to any Camelbak®, Nalgene®, or Source® hydration system with quick connect tube fittings.

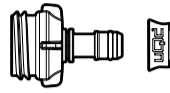

To connect to Camelbak® Hydrolink™ connectors remove the UQC rubber spacer and push the end into the Hydrolink™ until you feel and hear it "click" in place. Press the button and pull to remove.

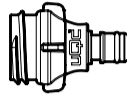

To connect to Nalgene® or Source® connectors install the UQC rubber spacer and push the end into the connector until you feel and hear it "click" in place. Press the buttons and pull to remove.

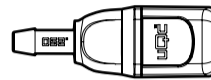

A mating UQC connector is included with your Frontier Pro for hydration systems that do not have quick connects. Press to connect. Press both buttons to release.

TO REMOVE/REPLACE BITE VALVE

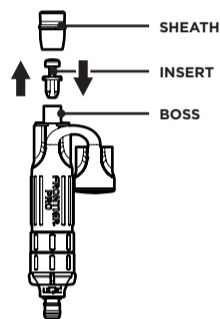

STEP 1

While holding the filter with one hand, grab the base of the bite valve with your other hand. Twist, then pull the valve straight off.

STEP 2

To replace Bite Me™ Valve, press the core insert into the boss until it bottoms out on the rim inside the boss.

STEP 3

Wet the inside surface of the sheath and press it over the insert and boss until it bottoms out at the base of the boss.

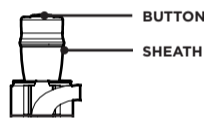

STEP 4

Position the sealing rim of the sheath so that the "button" protrudes slightly above the rim of the sheath.

AS A STRAW FILTER

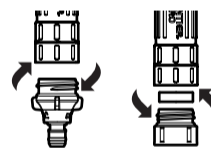

STEP 1

If the UQC pre-filter adapter is attached to filter casing, unscrew and remove.

STEP 2

Insert a pre-filter disk into the pre-filter/ straw adapter and screw adapter to the base of the filter.

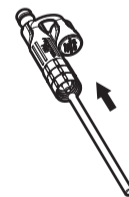

STEP 3

Attach included drinking straw to the tube connection on the base of the straw adapter.

STEP 4

Pull on the Cap Strap™ and position the cap to the side of the filter casing.



STEP 5

Place drinking straw in water source and sip through bite valve.

CAUTION — To avoid cross contamination: Do not handle filter with wet hands that have been exposed to contaminated water. Do not submerge filter or mouthpiece in contaminated water.

WITH A HYDRATION PACK

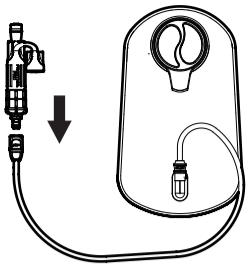

STEP 1

Screw the UQC pre-filter adapter snugly into the base of the filter and connect directly to the hydration system quick connect.

STEP 2

Drink from the Frontier Pro instead of the hydration system's bite valve.

GRAVITY FLOW SETUP

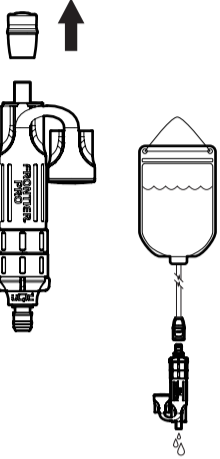

STEP 1

Remove the bite valve.

STEP 2

Attach Frontier Pro to the outlet tubing of the reservoir using the UQC pre-filter adapter.

STEP 3

Hang the reservoir with the Frontier Pro at the lowest point and allow gravity to force water through the filter.

STEP 4

Increase the distance between the reservoir and the filter to improve the flow rate.

TO REMOVE OR REPLACE PRIMARY FILTER

The Frontier GRN Line Series III filter is rated to filter at least 50 gallons of water. Replace filter when flow rate slows down or when unpleasant taste and odor is noticeable.

STEP 1

If UQC pre-filter adapter is attached to filter casing, unscrew and remove.

STEP 2

Unscrew the used filter cartridge and remove from the casing.

STEP 3

Screw the replacement filter into the casing and tighten by hand.

STEP 4

Insert new pre-filter disk into the UQC pre-filter adapter and screw snugly into the base of the filter casing.

CAUTION – To avoid cross contamination: Do not handle filter with wet hands that been exposed to contaminated water.

TO REMOVE/REPLACE PRE-FILTER DISK



STEP 1

Unscrew UQC pre-filter adapter or straw adapter from the base of the filter casing.

STEP 2

Remove the pre-filter disk from the adapter.

STEP 3

Place a new pre-filter disk into the adapter or straw adapter.

STEP 4

Screw the UQC pre-filter adapter snugly into the base of the filter casing.

Filter Storage

- Remove and discard the pre-filter disk.
- Remove the filter cartridge, and allow filter to air dry at room temperature for at least 48 hours prior to storing.
- Once dry, store in a cool dry location. Do not store used filter in a sealed container.
- Do not freeze filter or expose filter to extreme temperatures.
- Insert a new pre-filter disk prior to next use.

Note: DO NOT FREEZE. Freezing a wetted filter may damage the filter media and compromise filter integrity.

TECHNICAL INFORMATION

LIMITED WARRANTY AND DISCLAIMER

Aquamira Technologies, Inc. warrants all product to be free from defects in workmanship and materials for one year from the date of purchase by the consumer, or for the duration of the imprinted shelf life. Filter clogging or normal wear is not a defect. If you are not satisfied with the performance of an Aquamira Technologies, Inc. product, Aquamira Technologies, Inc. will repair or replace the product.

Aquamira Technologies hereby excludes any expressed or implied warranties of fitness for a particular purpose. The following is made in lieu of any such warranties: The information and specifications supplied by Aquamira Technologies, Inc. are based on standard laboratory test conditions and are believed to be reliable, but Aquamira Technologies, Inc. does not guarantee that any result shown or claimed will be obtained. Before using any Aquamira product, the user shall determine the suitability and fitness of the products for their intended use. The effectiveness of Aquamira products may be limited by environmental or hygienic conditions, such as use with contaminated hands, recontamination after filtration or treatment, failure to maintain a sterile mouthpiece or downstream equipment, sharing with multiple users, exposure to extreme environmental conditions such as heat, freezing, severe shock such as drops or other impact that may damage the integrity of the filter, seals or connections etc. The user assumes all risks and liability in connection with its own tests and use. Aquamira Technologies, Inc. shall not be liable for any injury, loss or damage, direct or consequential, resulting out of or from the use, misuse, or inability to use Aquamira Technologies, Inc. products. inability to use Aquamira products.

FILTER CARTRIDGE

PARAMETER	GRN Line Series III Filter
Service Life	50 Gal. (189 L)
Flow Rate	up to 500 ml/min
Operating Temperatures	35-120° F (1.6-49° C)
Operating Pressures	0-3 psi (0-0.211 kg f/cm ²)
Use Conditions	Use best water source available, quality of the source water may vary, use only Aquamira GRN Line Series III filters. We recommend pretreating water with Aquamira® Water Treatment Drops (#67202)* if biological/viral quality of source water is uncertain.

*Sold separately

Removal

GRN LINE BACTERIA PROTECTION

Bacteria Removal ≥99.9999%
Cyst Removal ≥99.95%

MEETS US EPA BIOLOGICAL PURIFIER TEST
STANDARD FOR REDUCTION OF BACTERIA & CYSTS

Chlorine, Chemical, Taste & Odor Removal

MEETS OR EXCEEDS ANSI/NSF 42

CERTIFICATIONS AND PATENTS



Certified by IAPMO R&T to NSF/ANSI 372 for lead free content. Meets US EPA Microbiological Purifier test standard for the reduction of cysts and bacteria.

Protected by the following US Patents: #D559349 #D570457 #6039305 #7862720

aquamira.

917 West 600 North, Logan, UT 84321
ph: (877) 644-4650
www.aquamira.com
© Copyright 2016 Aquamira Technologies, Inc.

015007C

aquamira.